

MORGAN COUNTY, OHIO

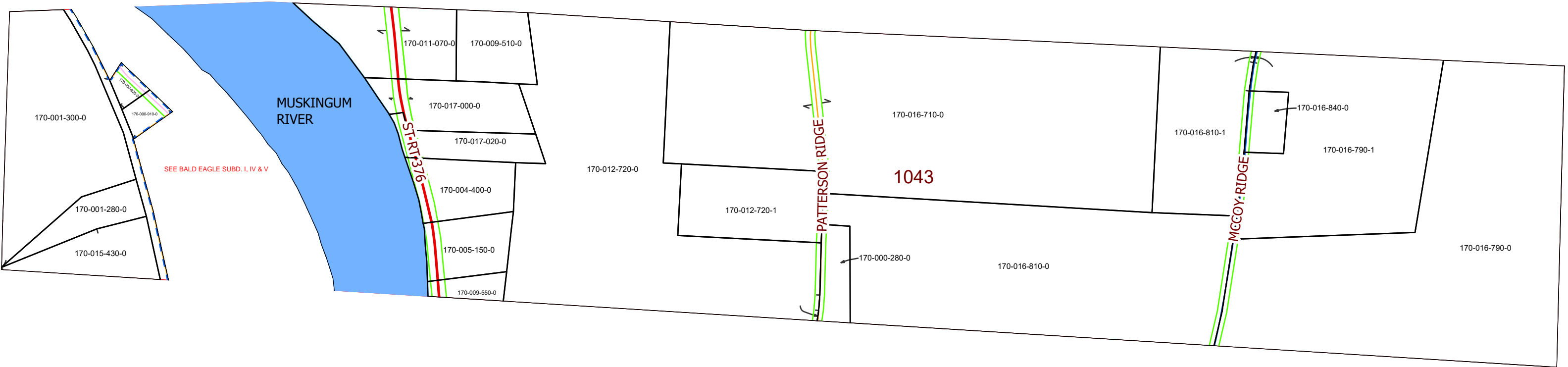

SEE BALD EAGLE SUBD. I, IV & V

WINDSOR TWP. FRAC. 1043, T-9, R-11, OHIO CO. PURCHASE

PIN	Owner	LegalDescr	VOL	PAGE
U/I				
170-000-920-0	ALLMAN JOHN D	R11 T09 S00 FR 1043	OR234	5827
170-000-910-0	ALLMAN JOHN D	R11 T09 S00 FR 1043	OR234	5827
170-000-280-0	BARRY FAMILY LIVING TRUST C/O RAYMOND C	R11 T09 S00 FR 1043	OR121	122
170-001-300-0	BLOOMFIELD PATRICIA A	R11 T09 S00 FR 1043	D.V 151	707
170-001-280-0	BLOOMFIELD PATRICIA A	R11 T09 S00 FR 1043	D.V 151	707
170-012-720-1	BRAGG ANDREW D & DONNA L REGER	R11 T09 S00 SD 21	OR177	405
170-012-720-0	CRITES EVERETT L SR & JUDITH C	R11 T09 S00 FR 1043	OR207	2035
170-004-400-0	CRITES EVERETT L SR & JUDITH C	R11 T09 S00 FR 1043	OR226	3279
170-017-000-0	CRITES EVERETTE L & JUDITH COLLEEN	R11 T08 S00 FR 1043	OR234	2387
170-011-070-0	GRAHAM ARLENE KAY	R11 T09 S00 FR 1043	D.V 200	394
170-009-550-0	HEISLER DONALD & VALERIE	R11 T09 S00 FR 1043	OR232	914
170-005-150-0	MANTZ MARK & MELISSA & MOLLY	R11 T09 S00 FR 1043	OR226	3140
170-015-430-0	UNRUE PATRICIA L	R11 T09 S00 FR 1043	OR8	654
170-016-810-0	WHITE DONALD D & LYNN G	R11 T09 S00 FR 1043	OR111	601
170-016-710-0	WHITE DONALD D & LYNN G	R11 T08 S00 FR 1043	OR111	601
170-016-840-0	WHITE RONALD L	R11 T09 S00 FR 1043	D.V 195	16
170-016-810-1	WHITE RONALD L	R11 T09 S00 FR 1043	OR111	608
170-016-790-1	WHITE RONALD L	R11 T09 S00 FR 1043	OR47	134
170-016-790-0	WHITE RONALD L	R11 T09 S00 FR 1043	OR111	601
170-017-020-0	WINEBRENNER WILLIAM	R11 T09 S00 FR 1043	D.V 164	527
170-009-510-0	YOST WILLIAM G & GEORGE III	R11 T09 S00 FR 1043	OR235	3186

Boundaries

Type

- County
- Hidden
- Hydro
- Parcel
- ROW
- Section
- Lot

..... <all other values>



08/10/2020

